



TECHNICAL BULLETIN HALOGEN LAMP

**MR16 EYE Dichro-Cool®
JR8551
50MR16CG/12°/10000H/EXT**

ANSI Code: EXT/CG

Product Code: 67890

- Features:**
- Single Ended
 - Super Long Life
 - White Light
 - Use: General Lighting, Retail, Home, Office, Landscape

PERFORMANCE DATA

| | | |
|--------------------------|-----------|---------|
| Center Beam Intensity | 9500 | cd |
| Color Temperature | 3050 | K |
| Color Rendering Index | 100 | CRI |
| Beam Angle | 12 | (°) |
| Rated Average Life | 10,000 | h |
| Mirror Temperature (max) | 350 (662) | °C (°F) |
| Pinch Temperature (max) | 270 (518) | °C (°F) |

ELECTRICAL CHARACTERISTICS

| | | |
|-------------------|-----|---|
| Wattage | 50 | W |
| Voltage | 12 | V |
| Current (nominal) | 4.2 | A |

PHYSICAL DESCRIPTION

| | | |
|------------------------|------------|---------|
| Maximum Overall Length | 46 (1.8) | mm (in) |
| Reflector Diameter | 50.7 (2.0) | mm (in) |
| Cover Glass Finish | Clear | |
| Base | GU 5.3 | |
| Filament | C-6 | |
| Operating Position | Universal | |
| Fuse | None | |

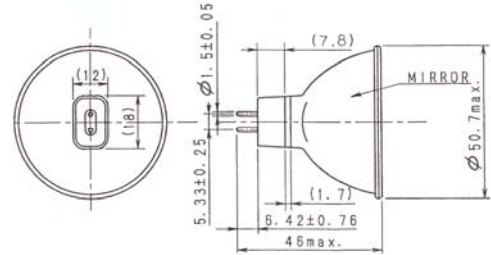

Beam Angle 12°

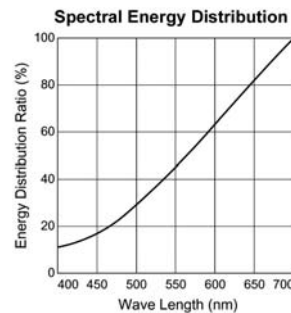
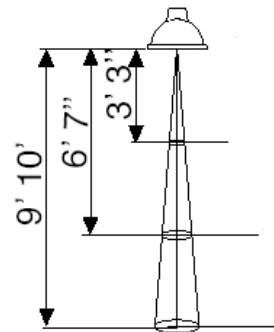

Lumen Maintenance

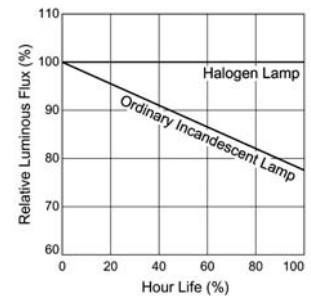

Mortality Curve

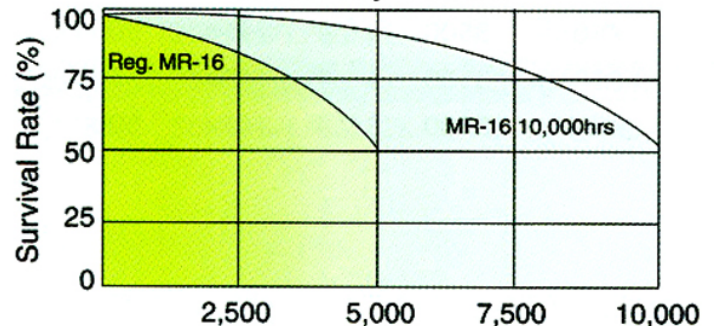

ISO 9001:2008 Certified ISO 14001:2004 Certified

OSHAS 18001:2007 Certified ISO 17025:2005 Accredited



**EYE LIGHTING INTERNATIONAL
OF NORTH AMERICA, INC.**
A SUBSIDIARY OF IWASAKI ELECTRIC CO., LTD.

Address: 9150 Hendricks Rd., Mentor, OH 44060
Phone: 888-665-2677 Fax: 800-811-7395 E-Mail: sales@eyelighting.com
Phone: (440) 350-7000 Fax: (440) 350-7001 Web: www.eyelighting.com



⚠WARNING

RISK OF ELECTRIC SHOCK

- Turn power off before inspection, installation or removal

RISK OF FIRE

- Keep combustible materials away from lamp during operation
- Use in fixture rated for this product

PRESSURIZED LAMP - UNEXPECTED LAMP RUPTURE MAY CAUSE INJURY, FIRE, OR PROPERTY DAMAGE

- Use eye protection when handling lamp
- Do not use lamp if outer glass is scratched or broken
- Do not exceed rated voltage
- Do not turn on lamp until fully installed
- Dispose of lamp in a closed container

⚠CAUTION

RISK OF BURN

- Allow lamp/fixture to cool before handling.

LAMP MAY SHATTER AND CAUSE INJURY

- Do not use lamp if outer glass is scratched or broken

ISO 9001:2008 Certified

ISO 14001:2004 Certified

OSHAS 18001:2007 Certified

ISO 17025:2005 Accredited



EYE LIGHTING INTERNATIONAL
OF NORTH AMERICA, INC.

A SUBSIDIARY OF IWASAKI ELECTRIC CO., LTD.

Address: 9150 Hendricks Rd., Mentor, OH 44060

Phone: 888-665-2677 Fax: 800-811-7395 E-Mail: sales@eyelighting.com

Phone: (440) 350-7000 Fax: (440) 350-7001 Web: www.eyelighting.com