



TECHNICAL BULLETIN HALOGEN LAMP

**MR16 EYE Dichro-Cool®
JR8351
35MR16CG/12°/10000H/FRB**

ANSI Code: FRB/CG

Product Code: 72367

- Features:**
- Single Ended
 - Super Long Life
 - White Light
 - Use: General Lighting, Retail, Home, Office, Landscape

PERFORMANCE DATA

Center Beam Intensity	7400	cd
Color Temperature	3050	K
Color Rendering Index	100	CRI
Beam Angle	12	(°)
Rated Average Life	10,000	h
Mirror Temperature (max)	350 (662)	°C (°F)
Pinch Temperature (max)	270 (518)	°C (°F)

ELECTRICAL CHARACTERISTICS

Wattage	35	W
Voltage	12	V
Current (nominal)	2.9	A

PHYSICAL DESCRIPTION

Maximum Overall Length	46 (1.8)	mm (in)
Reflector Diameter	50.7 (2.0)	mm (in)
Cover Glass Finish	Clear	
Base	GU 5.3	
Filament	C-6	
Operating Position	Universal	
Fuse	None	

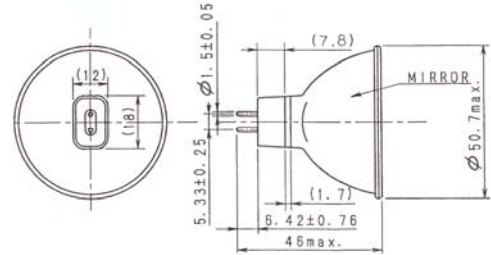

Beam Angle 12°

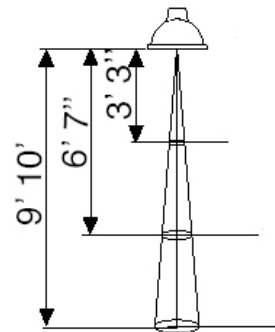

687 fc
8.3" dia.

172 fc
16.5" dia.

76 fc
24.8" dia.

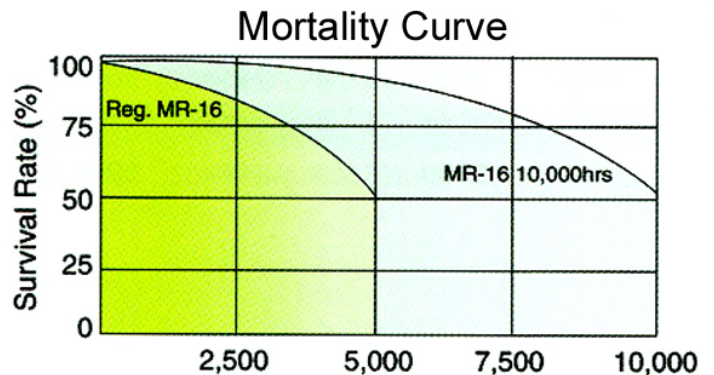
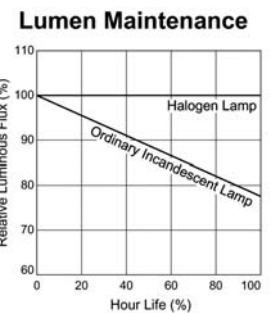
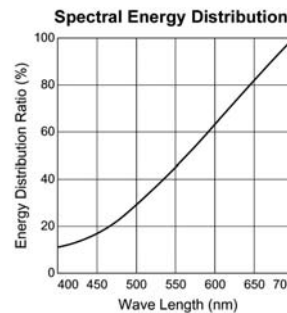

ISO 9001:2008 Certified ISO 14001:2004 Certified

OSHAS 18001:2007 Certified ISO 17025:2005 Accredited



**EYE LIGHTING INTERNATIONAL
OF NORTH AMERICA, INC.**
A SUBSIDIARY OF IWASAKI ELECTRIC CO., LTD.

Address: 9150 Hendricks Rd., Mentor, OH 44060
Phone: 888-665-2677 Fax: 800-811-7395 E-Mail: sales@eyelighting.com
Phone: (440) 350-7000 Fax: (440) 350-7001 Web: www.eyelighting.com



⚠WARNING

RISK OF ELECTRIC SHOCK

- Turn power off before inspection, installation or removal

RISK OF FIRE

- Keep combustible materials away from lamp during operation
- Use in fixture rated for this product

PRESSURIZED LAMP - UNEXPECTED LAMP RUPTURE MAY CAUSE INJURY, FIRE, OR PROPERTY DAMAGE

- Use eye protection when handling lamp
- Do not use lamp if outer glass is scratched or broken
- Do not exceed rated voltage
- Do not turn on lamp until fully installed
- Dispose of lamp in a closed container

⚠CAUTION

RISK OF BURN

- Allow lamp/fixture to cool before handling.

LAMP MAY SHATTER AND CAUSE INJURY

- Do not use lamp if outer glass is scratched or broken

ISO 9001:2008 Certified ISO 14001:2004 Certified

OSHAS 18001:2007 Certified ISO 17025:2005 Accredited



EYE LIGHTING INTERNATIONAL
OF NORTH AMERICA, INC.

A SUBSIDIARY OF IWASAKI ELECTRIC CO., LTD.

Address: 9150 Hendricks Rd., Mentor, OH 44060
Phone: 888-665-2677 Fax: 800-811-7395 E-Mail: sales@eyelighting.com
Phone: (440) 350-7000 Fax: (440) 350-7001 Web: www.eyelighting.com